

# RM 135

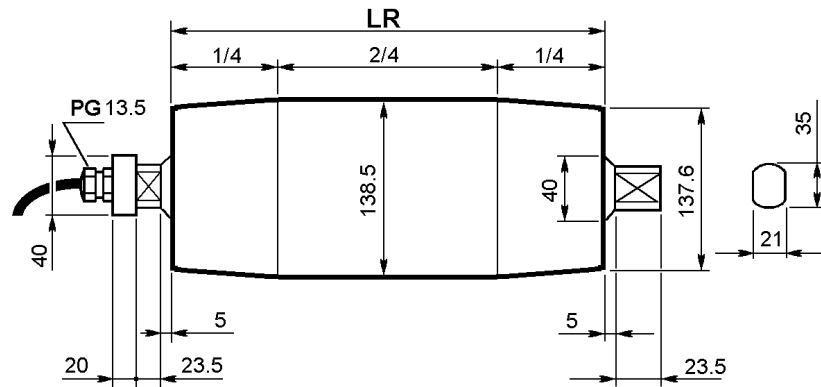

kW HP	Poli Poles n.	V m/s	M Nm	F N	L min. mm	Peso/Weight [kg]											
						LR [mm]											
						350	400	500	550	600	650	700	750	800	850	900	950
<b>Motore trifase / Threephase motor</b>																	
0.37 0.50	4	0.20	116	1720	350	15	16	16.5	17	17.5	18	18.5	19	19.5	20	20.5	21
		0.28	82.9	1228	350												
		0.33	72.6	1075	350												
		0.40	58	860	350												
		0.50	46.4	688	350												
		0.63	36.9	546	350												
0.25 0.33	6	0.13	120.7	1788	400	18	18.5	19	21	23	24	25	26	27	28.5	30	
		0.15	104.6	1549	400												
		0.21	74.7	1107	400												
		0.25	62.7	930	400												
		0.32	49	728	400												
0.55 0.75	2	0.40	86.3	1278	400	18	18.5	19	21	23	24	25	26	27	28.5	30	
		0.50	69	1023	400												
		0.63	51.8	812	400												
		0.8	43.1	639	400												
		1.0	34.5	511	400												
		1.25	27.6	409	400												
<b>Motore monofase / Single-phase motor</b>																	
0.37 0.50	4	0.32	72.6	1075	400	18	18.5	19	21	23	24	25	26	27	28.5	30	
		0.40	58	860	400												
		0.50	46.4	688	400												
		0.63	36.9	546	400												

V = Velocità del nastro                      m/s  
 M = Coppia all'asse del motorullo        Nm  
 F = Trazione del nastro                      N  
 L = Larghezza minima del mantello      mm

V = Belt speed                                      m/s  
 M = Drummotor axis torque                Nm  
 F = Belt pull                                        N  
 L = Min. face width                              mm