

# RM 160

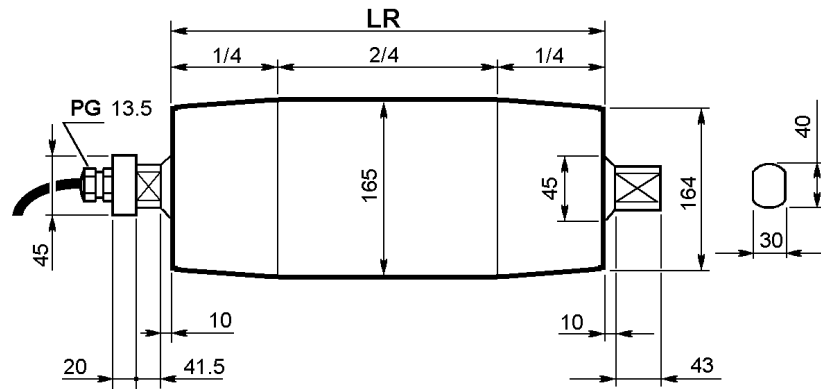

kW HP	Poli Poles n.	V m/s	M Nm	F N	L min. mm	Peso/Weight [kg]															
						LR [mm]															
Motore trifase/Threephase motor																					
0.37 0.50	4	0.20	137	1720	400	30	31.5	33	35	36	37.5	39	41	42	43	44	45	47	49	50	
		0.28	98	1228	400																
		0.33	83	1042	400																
		0.40	68	860	400																
		0.50	55	688	400																
		0.63	43	546	400																
		0.80	34	430	400																
	1.00	27	344	400																	
	6	0.21	131	1638	400																
		0.25	110	1376	400																
0.36		86	1075	400																	
0.75 1.00	4	0.28	146	1826	400	30	31.5	33	35	36	37.5	39	41	42	43	44	45	47	49	50	
		0.33	123	1549	400																
		0.40	102	1278	400																
		0.50	81	1025	400																
		0.63	65	812	400																
		0.80	51	639	400																
		1.00	41	511	400																

V	= Velocità del nastro	m/s
M	= Coppia all'asse del motorullo	Nm
F	= Trazione del nastro	N
L	= Larghezza minima del mantello	mm

V	= Belt speed	m/s
M	= Drummotor axis torque	Nm
F	= Belt pull	N
L	= Min. face width	mm