

RM 72

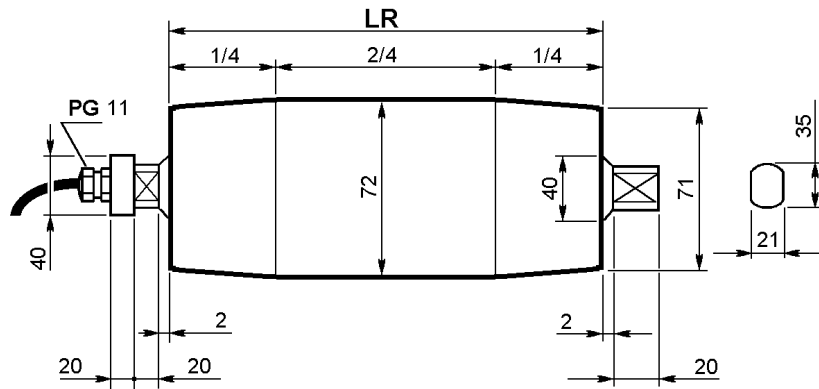

kW HP	Poli Poles n.	V m/s	M Nm	F N	L min. mm	Peso/Weight [kg]						
						LR [mm]						
						312	362	412	462	512	562	612
Motore trifase / Threephase motor												
0.05 0.07	2	0.16	10.5	280	312	3.8	4.0	4.1	4.4	4.7	5.0	5.2
		0.52	5.2	89	312	3.8	4.0	4.1	4.4	4.7	5.0	5.2
	4	0.08	20.9	581	327	4.0	4.2	4.4	4.6	4.9	5.3	5.5
		0.17	9.8	273	312	3.8	4.0	4.1	4.4	4.7	5.0	5.2
Motore monofase / Single-phase motor												
0.05 0.07	2	0.15	10.5	290	312	3.8	4.0	4.1	4.4	4.7	5.0	5.2
		0.52	3.2	89	312	3.8	4.0	4.1	4.4	4.7	5.0	5.2
	4	0.08	20.8	501	327	4.0	4.2	4.4	4.6	4.9	5.3	5.5
		0.17	9.8	273	312	3.8	4.0	4.1	4.4	4.7	5.0	5.2

V	= Velocità del nastro	m/s
M	= Coppia all'asse del motorullo	Nm
F	= Trazione del nastro	N
L	= Larghezza minima del mantello	mm

V	= Belt speed	m/s
M	= Drummotor axis torque	Nm
F	= Belt pull	N
L	= Min. face width	mm